

# AIR PRESSURE REGULATOR - VAYU™ STANDARD

**SHAVO**  
FIRST NAME IN PNEUMATICS

SR60 (G ¼, G ⅜, G ½, G ¾)

## FEATURES

- Shavo's Vayu™ Series Standard Range Pressure Regulators Diaphragm operated, respond to flow demand and line pressure changes efficiently.
- Positive valve sealing, large passages & operating to give free air flow.
- Large size low torque knob to adjust pressure make it designers' first choice



PARAMETERS	SPECIFICATIONS	
Pipe Threads	G 1/4, 3/8, 1/2, 3/4 Parallel (F)	- Standard
	BSPT. / NPT	- Optional
Type	Relieving diaphragm	- Standard
	Non-Relieving diaphragm	- Optional
Body Material	Al. Alloy die-cast	- Standard
Adjustment	Non-rising plastic knob	- Standard
	Metal "T" Handle'	- Optional
Maximum Inlet Pressure	21.0 kg/cm <sup>2</sup> (300 psig)	
Maximum Operating Temperature (ambient)	80° C (175° F)	
Regulated secondary outlet pressure (spring range) and recommended pressure gauge ranges available (in kg/cm <sup>2</sup> )	Spring Range	Gauge Range
	0.21-2.10 kg/cm <sup>2</sup>	2-5 kg/cm <sup>2</sup>
	0.35-3.50 kg/cm <sup>2</sup>	0-4 kg/cm <sup>2</sup>
	0.87-8.75 kg/cm <sup>2</sup>	0-10 kg/cm <sup>2</sup>
	1.00-10.0 kg/cm <sup>2</sup>	0-16 kg/cm <sup>2</sup>
	1.75-17.5 kg/cm <sup>2</sup>	0-20 kg/cm <sup>2</sup>
Gauge size	50 mm OD Nominal	
Gauge port size	Rc 1/8 BSP Tr.	
Gauge connection	Back	
Standard Nominal Flow rate (at 10 bar supply pressure and 1 bar pr drop in sec. pressure of 6 bar)	G 1/4	30 dm <sup>3</sup> /sec (62 scfm)
	G 3/8	40 dm <sup>3</sup> /sec (83 scfm)
	G 1/2	60 dm <sup>3</sup> /sec (129 scfm)
	G 3/4	80 dm <sup>3</sup> /sec (172 scfm)
Mounting Bracket	Optional	
Panel Mounting	Standard - Available	

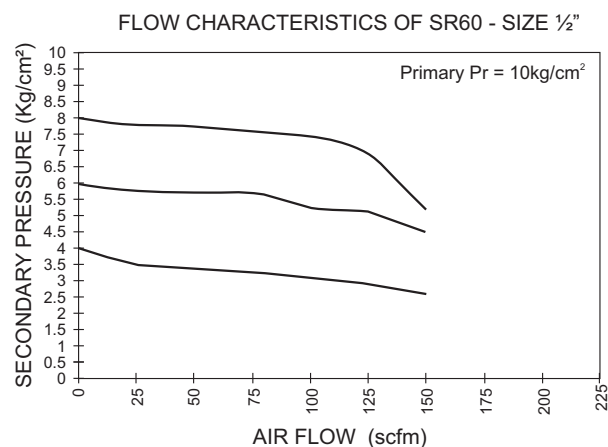
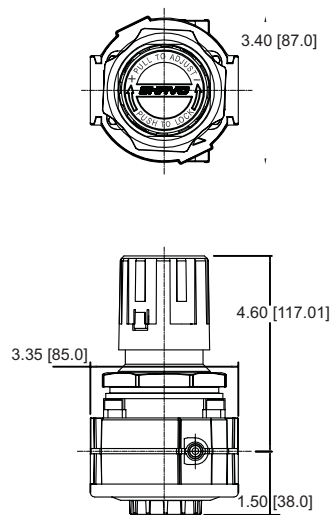

# AIR PRESSURE REGULATOR - VAYU™ INTERMEDIATE

**SHAVO**  
FIRST NAME IN PNEUMATICS

SR60 (G 1/4, G 3/8, G 1/2)

Size	Flow (dm <sup>3</sup> /s)	Range Kg/cm <sup>2</sup>	Operation	Model
G 1/4	30 dm <sup>3</sup> /sec	0-8.75	Relieving	SR60-2G-RNMN
G 3/8	40 dm <sup>3</sup> /sec	0-8.75	Relieving	SR60-3G-RNMN
G 1/2	60 dm <sup>3</sup> /sec	0-8.75	Relieving	SR60-4G-RNMN
G 3/4	80 dm <sup>3</sup> /sec	0-8.75	Relieving	SR60-6G-RNMN

## Option Selector

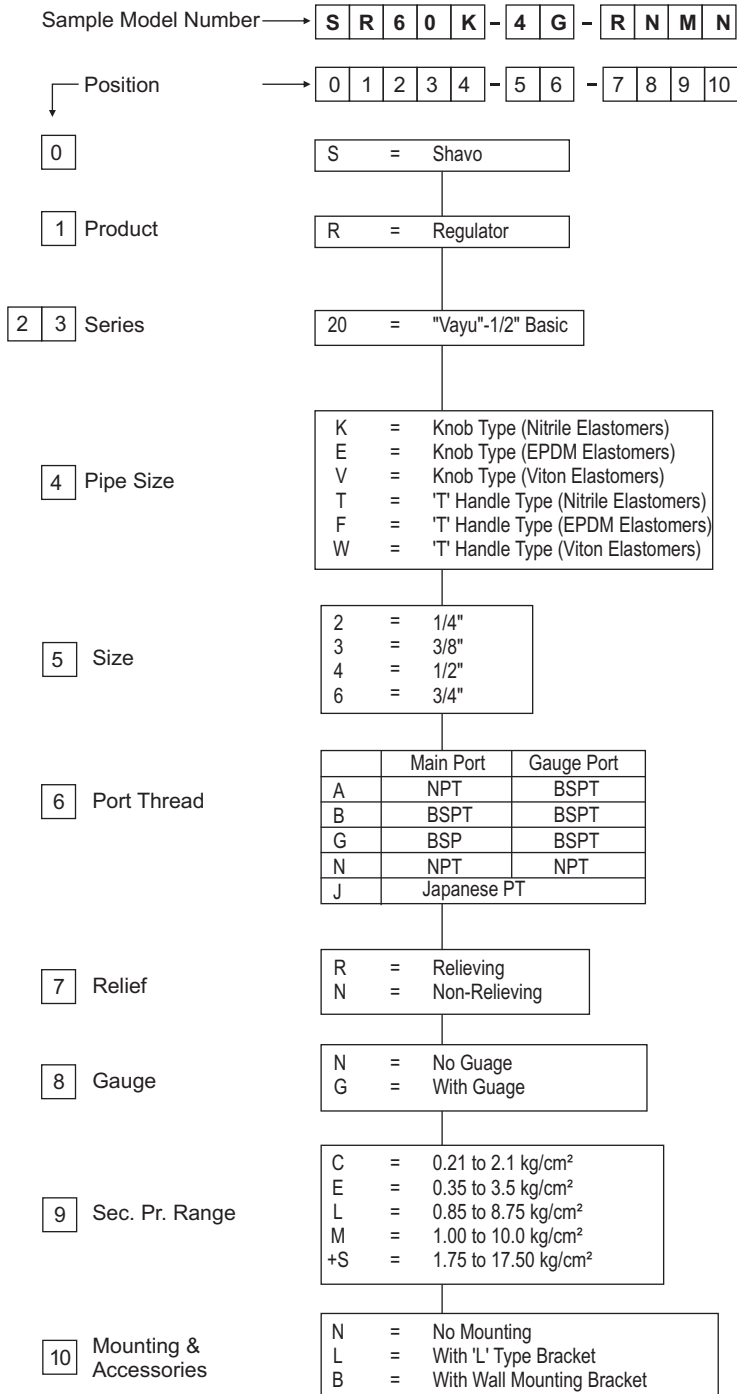

Note: Panel mounting nut is Standard on all R20 units.  
+ Available only with "T" handle