

COMPRESSED AIR FILTER - LARGE

SHAVO
FIRST NAME IN PNEUMATICS

SF17 (G1, G1½)

FEATURES

- Shavo's Designer Series Large Flow Range general purpose Filter removes upto 99% of the liquid water.
- Design of the filter elements gives both surface and depth filtration for cleaner air.
- Ideally suited for header lines and large flow rated tools and cylinder operations.



PARAMETERS	SPECIFICATIONS
Pipe Threads	G 1, 1 ½ Parallel (F) - Standard
Filter Element Size	5, 50 micron.
Element Material	Plastic (Polypropylene) - Standard Sintered Bronze - Optional
Body Material	Al. Alloy die-cast
Bowl Material	Al. Alloy Metal with sight glass - Standard
Maximum Inlet Pressure	17.5 kg/cm ² (250 psig)
Maximum Operating Temperature (ambient)	80° C (175° F)
Standard Nominal Flow Rate (at 6 bar supply pressure and 1 bar pressure drop)	333 dm ³ /sec (700 scfm)
Drain	Manual - Standard Automatic - Optional

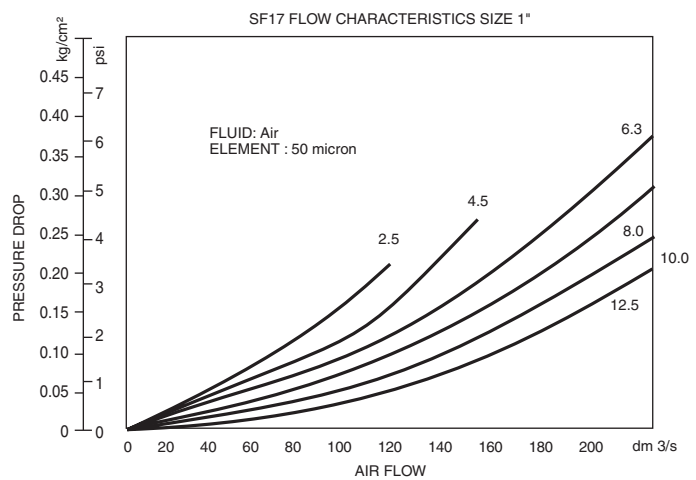
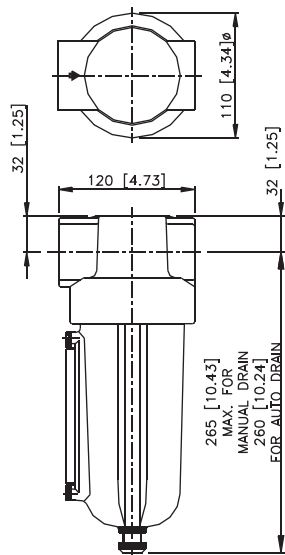

* Technical know-how, design and drawings originally from C.A. Norgren Co. USA

COMPRESSED AIR FILTER - LARGE

SHAVO
FIRST NAME IN PNEUMATICS

SF17 (G1, G1½)

Size	Flow (dm³/s)	Element (um)	Drain	Bowl	Model
G1	333 dm³/sec	50	Auto Manual	Metal Metal	SF17-800-A3DC SF17-800-M3DC
G 1 ½	333 dm³/sec	50	Auto Manual	Metal Metal	SF17-B00-A3DC SF17-B00-M3DC

Option Selector

Sample Model Number → **S F 1 7 8 0 0 M 3 D C**

Position → **0 1 2 3 4 5 6 7 8 9 10**

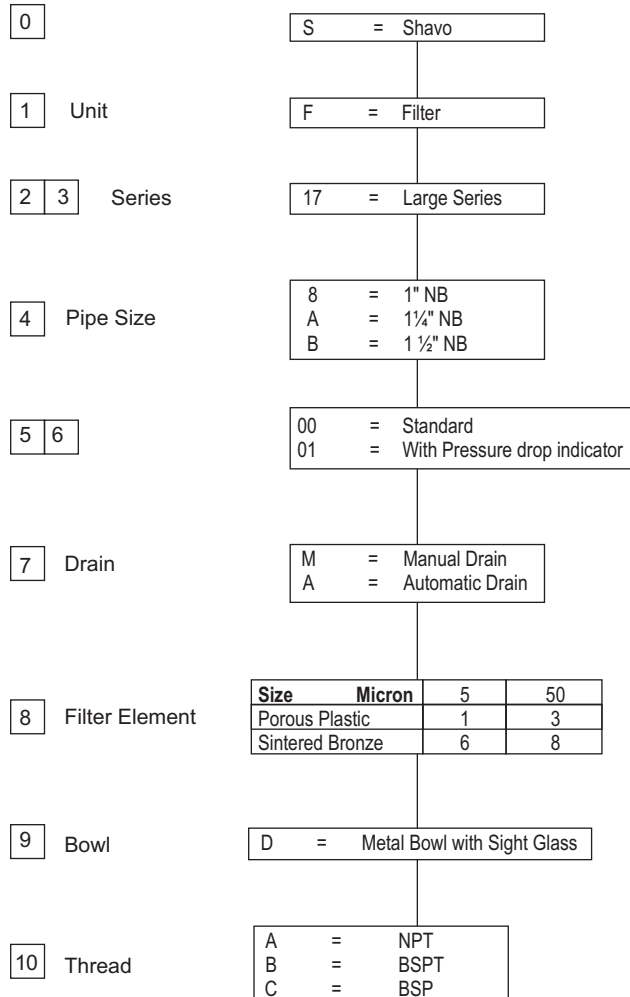

* Technical know-how, design and drawings originally from C.A. Norgren Co. USA

SHAVO

Mumbai, India.

Tel. : 022-2760 4700

Fax : 022-2760 4790

A011/2
0702