

COMPRESSED AIR FILTER - HIGH FLOW



SF18 (G 1½, G 2)

FEATURES

- Shavo's Very High Flow capacity direct ported Air Filter with high water removal efficiency and minimal pressure drop are used for removal of liquids and solid contaminants to protect air tools and equipment.
- Ideally suited for header lines and very high flow applications.



PARAMETERS	SPECIFICATIONS
Pipe Threads	G 1 ½, 2 Parallel (F) - Standard
Filter Element Size	5, 50 micron
Element Material	Sintered Bronze - Standard
Body Material	Al. Alloy die-cast
Bowl Material	Al. Alloy Metal with sight glass - Standard
Maximum Inlet Pressure	17.5 kg/cm ² (250 psig)
Maximum Operating Temperature (ambient)	80° C (175° F)
Standard Nominal Flow Rate (at 6 bar supply pressure and 1 bar pressure drop)	1000 dm ³ / sec (2100 scfm)
Drain	Automatic - Standard Manual - Optional

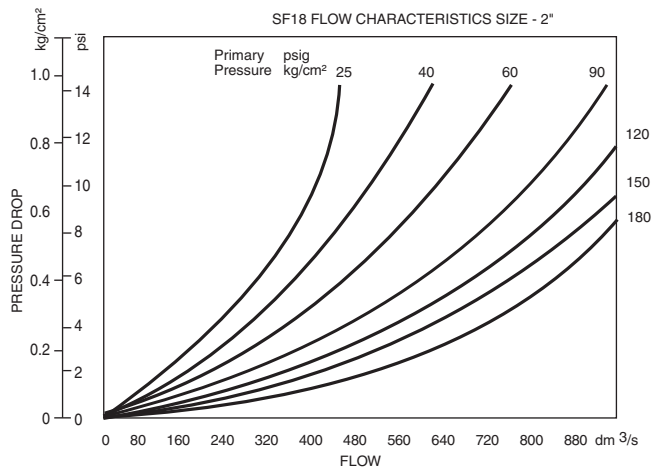
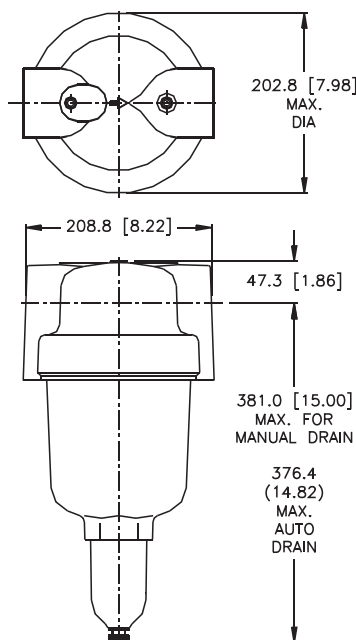

* Technical know-how, design and drawings originally from C.A. Norgren Co. USA

COMPRESSED AIR FILTER - HIGH FLOW

SHAVO
FIRST NAME IN PNEUMATICS

SF18 (G 1½, G 2)

Size	Flow (dm³/s)	Element (um)	Drain	Bowl	Model
G 1 ½	1000 dm³/sec	50	Auto	Metal	SF18-B00-A3DD
G 2	1000 dm³/sec	50	Auto	Metal	SF18-C00-A3DD

Option Selector

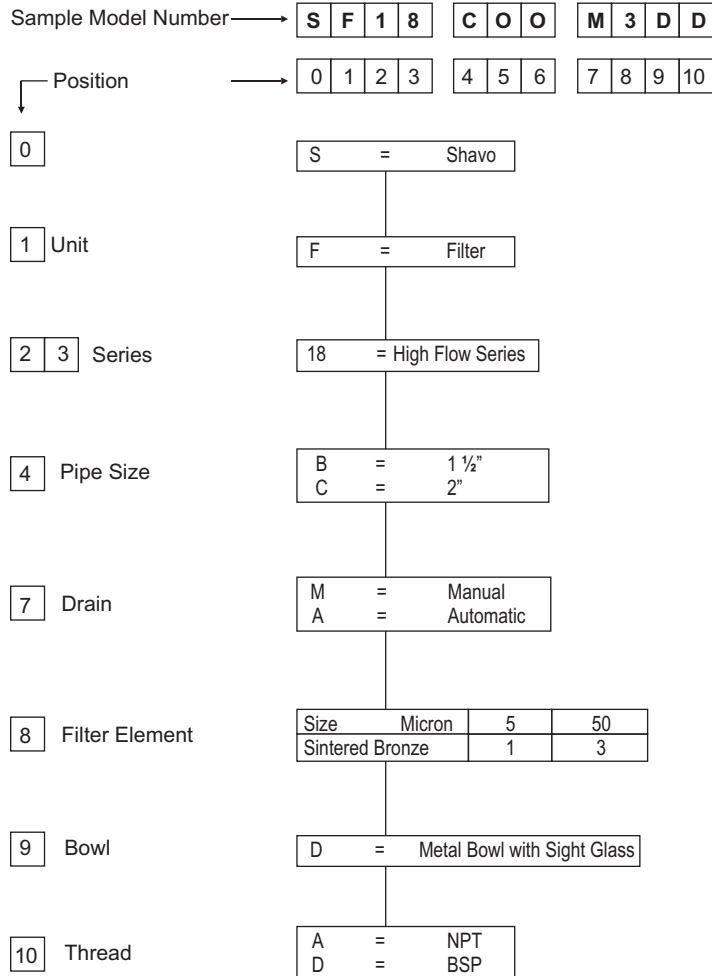

* Technical know-how, design and drawings originally from C.A. Norgren Co. USA

SHAVO

Mumbai, India.

Tel. : 022-2760 4700

Fax : 022-2760 4790

A012/2
0702