

HIGH EFFICIENCY, HIGH FLOW OIL REMOVAL FILTER

SHAVO
FIRST NAME IN PNEUMATICS

SF46 (G 1/2, G 3/4, G 1)

FEATURES

- Shavo's Designer Series High Flow Capacity Oil Removal Filter is designed for use where exceptionally clean air is required free from oil.
- Coalescing Filter elements remove most of the oil mist (+99.9%) from the air stream.



PARAMETERS	SPECIFICATIONS	
Pipe Threads	G 1/2, 3/4, 1 Parallel (F)	- Standard
	BSPT _r / NPT	- Optional
Element Material	Synthetic fibre & Polyurethane foam	
Body Material	Al. Alloy die-cast	
Bowl Material	Al. Alloy Metal with sight glass	
Maximum Inlet Pressure	17.5 kg/cm ² (250 psig)	
Operating Temperature Range	-6° C (20° F) to 80° C (175° F)	
Recommended flow (at an inlet pressure of 7 kg/cm ²)	G 1/2	28 dm ³ /sec (59 scfm)
	G 3/4	43 dm ³ /sec (90 scfm)
	G 1	57 dm ³ /sec (120 scfm)
Particle Removal	upto 0.01 micron	
Maximum Oil Removal content	upto 0.01 ppm at + 21° C	
Drain	Standard - Manual Optional - Automatic	
Differential Pressure Indicator	Optional	
Note : Recommended	Use Pre-Filter with 5 micron element.	

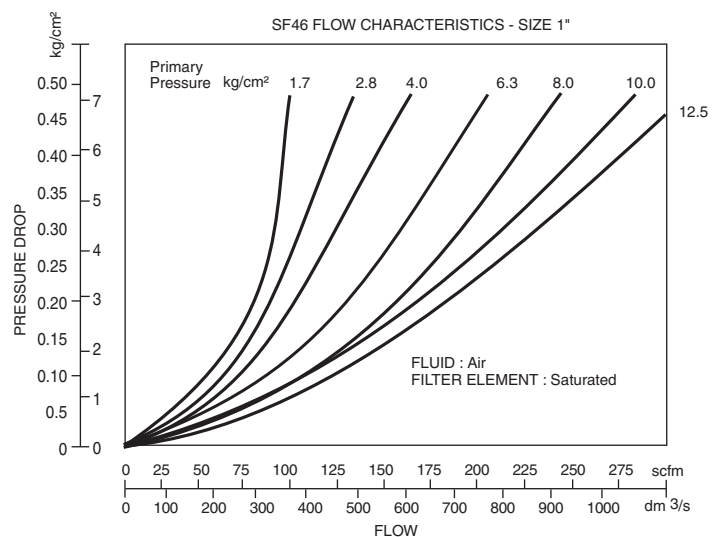
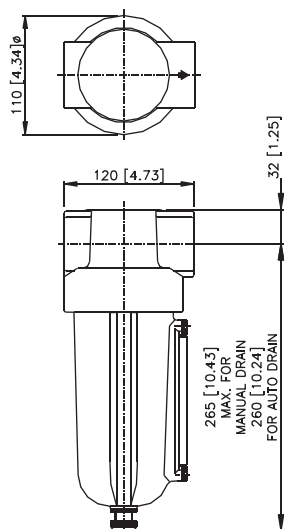

* Technical know-how, design and drawings originally from C.A. Norgren Co. USA

HIGH EFFICIENCY, HIGH FLOW OIL REMOVAL FILTER

SHAVO

FIRST NAME IN PNEUMATICS

SF46 (G 1/2, G 3/4, G 1)

Size	Flow (dm ³ /s)	Element	Drain	Bowl	Model
G 1	57 dm ³ /sec	Synthetic Fibre & Polyurethane Foam	Manual	Transparent	SF46-800-MODC
			Auto	Transparent	SF46-800-AODC

Option Selector

Sample Model Number → **S F 4 6 4 0 0 M O D C**

Position → **0 1 2 3 4 5 6 7 8 9 10**

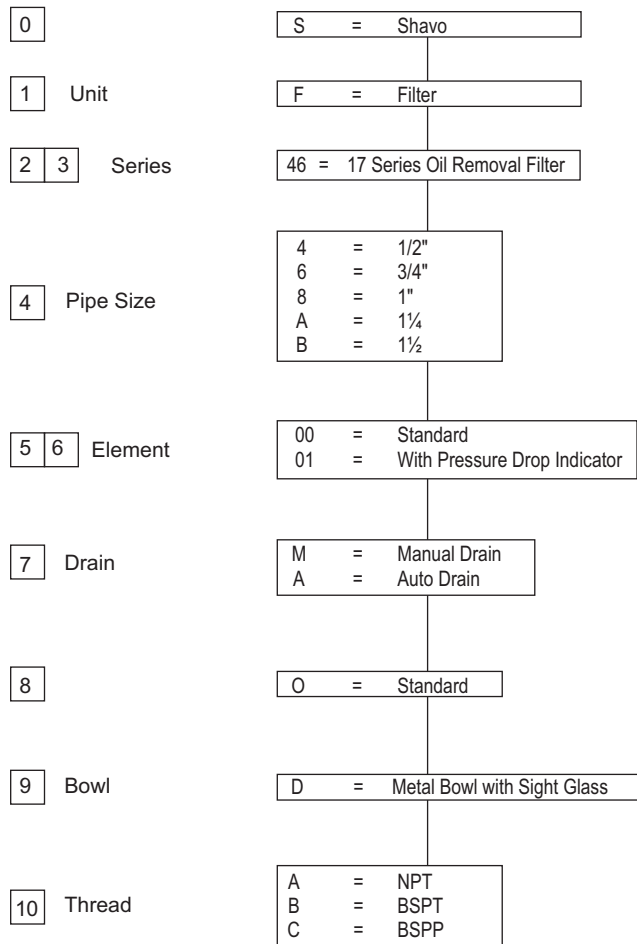

* Technical know-how, design and drawings originally from C.A. Norgren Co. USA

SHAVO

Mumbai, India.

Tel. : 022-2760 4700

Fax : 022-2760 4790

A014/2
0702