

AIR PRESSURE REGULATOR - Plug - In

SHAVO
FIRST NAME IN PNEUMATICS

SR13 (G 1/4, G 3/8, G 1/2, G 3/4, G 1)

FEATURES

- Shavo's general application Regulator-Diaphragm type.
- Rigid Yoke available for immediate installation in the compressed air pipeline system.
- Adjusting knob has 'snap-action lock' for pressure setting.
- Innovative Plug-in-Design permits units to be removed from the line for extremely rapid servicing or replacement without disturbing pipework.



PARAMETERS	SPECIFICATIONS		
Pipe Threads	G 1/4, 3/8, 1/2, 3/4, 1 Parallel (F)	-	Standard
	BSPT. / NPT	-	Optional
Type	Relieving diaphragm	-	Standard
	Non-Relieving diaphragm	-	Optional
Body Material	Al. Alloy die-cast		
Adjustment	Non-rising plastic knob	-	Standard
	Metal "T" Handle	-	Optional
Maximum Inlet Pressure	21.0 kg/cm ² (300 psig)		
Max . Operating Temp. (ambient)	80°C (175° F)		
Regulated secondary outlet pressure (spring range) and recommended Pressure gauge ranges available (in kg/cm ²)		Spring Range	Gauge Range
	1	0.21 to 2.10	0 to 2.5
	2	0.35 to 3.50	0 to 4.0
	3	0.87 to 8.75	0 to 10
	4	1.00 to 10.0	0 to 16
	5	1.75 to 17.5	0 to 20
Gauge size	52 mm OD		
Gauge Port size	Rc 1/8 BSPT.		
Gauge connection	Back		
Standard Nominal Flow rate (at 10 bar supply pressure and 1 bar pressure drop of 6 bar secondary pressure)	1/4	25 dm ³ / sec (53 scfm)	
	3/8	42 dm ³ / sec (80 scfm)	
	1/2	95 dm ³ / sec (200 scfm)	
	3/4, 1	95 dm ³ / sec (200 scfm)	
Mounting Bracket	Optional		
Panel Mounting	Possible - Optional		
Ball Valve	Integrated exhaust type Shut-off valve for instant isolation available as optional.		

* Technical know-how, design and drawings originally from C.A. Norgren Co. USA

SHAVO

Mumbai, India.

Tel. : 022-2760 4700

Fax : 022-2760 4790

B006/1
0702

AIR PRESSURE REGULATOR - Plug - In

FIRST NAME IN PNEUMATICS

SR13 (G 1/4, G 3/8, G 1/2, G 3/4, G 1)

Size	Flow (dm ³ /s)	Range Kg/cm ²	Operation	Model
G 1/4	25 dm ³ /sec	0-8.75	Relieving	SR13-200-RNLC
G 3/8	42 dm ³ /sec	0-8.75	Relieving	SR13-300-RNLC
G 1/2	95 dm ³ /sec	0-8.75	Relieving	SR13-400-RNLC
G 3/4, 1	95 dm ³ /sec	0-8.75	Relieving	SR13-600-RNLC
Basic Unit				SR13-000-RNLO

Option Selector

Sample Model Number →

S R 1 3 4 0 0 R G L B - T

Position →

0 1 2 3 4 5 6 7 8 9 10 11

0

S = Shavo

7 Diaphragm

R = Relieving
N = Non-Relieving

1 Unit

R = Regulator

8 Gauge

G = With Gauge
N = Without Gauge

2 3 Series

13 = Plug - In series

9 Secondary Pressure Rating

C = 2.1 kg/cm²
E = 3.5 kg/cm²
L = 8.75 kg/cm²
M = 10.0 kg/cm²
S = 17.5 kg/cm²

4 Pipe Size

0 = No yoke basic unit only.
2 = 1/4"
3 = 3/8"
4 = 1/2"
6 = 3/4"
8 = 1"

10 Threading

B = BSP Taper
A = NPT
C = BSP Parallel
J = PT per JISB0203
O = No Yoke

5 6 Mounting

00 = Std. Unit Knob Type
01 = T' Handle Type

11 Ball Valve

T = With Ball Valve
blank = Without Ball Valve

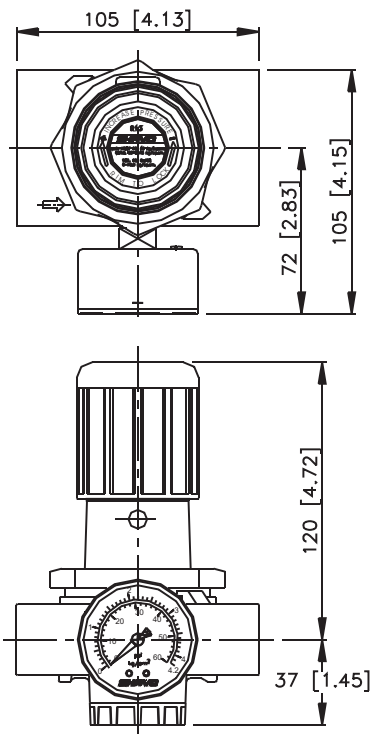

SR13 FLOW CHARACTERISTICS - SIZE 1/2"

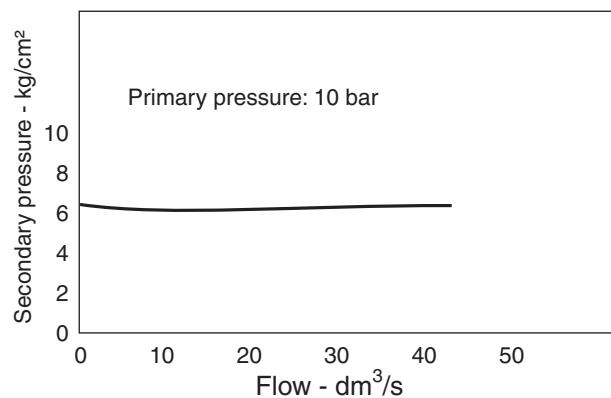

* Technical know-how, design and drawings originally from C.A. Norgren Co. USA