

AIR PRESSURE REGULATOR - MINIATURE

SHAVO
FIRST NAME IN PNEUMATICS

SRO7 (G 1/8, G 1/4)

FEATURES

- Shavo's Miniature Series Pressure Regulator Diaphragm operated.
- Non-rising adjusting knob with "Snap-Action Lock" for locking positively the pressure setting.
- Plastic bonnet threaded for panel mounting. Rust-free Zinc Pressure Die Cast Body. Powder-coated for longer life.



PARAMETERS	SPECIFICATIONS	
Pipe Threads	G 1/8, 1/4 Parallel (F)	- Standard
	BSPT. / NPT	- Optional
Type	Relieving diaphragm	- Standard
	Non-Relieving diaphragm	- Optional
Body Material	Zinc Alloy die-cast	
Adjustment	Non-rising plastic knob	
Maximum Inlet Pressure	21.0 kg/cm ² (300 psig)	
Max. Operating Temp. (ambient)	80° C (175° F)	
Regulated secondary outlet pressure (spring range) and recommended Pressure gauge ranges available (in kg/cm ²).	Spring Range	Gauge Range
	0.07 to 0.70	0 to 2.5
	0.21 to 2.10	0 to 4.0
	0.35 to 3.50	0 to 10.0
	0.70 to 7.0	0 to 16.0
	1.00 to 10.0	0 to 20.0
Gauge size	40 mm OD	
Gauge Port size	Rc 1/8 BSPT.	
Gauge connection	Back	
Standard Nominal Flow rate (at 10 bar supply pressure and 1 bar drop in 6 bar sec. pressure)	G 1/8	6.3 dm ³ /sec (13 scfm)
	G 1/4	7.2 dm ³ /sec (15 scfm)
Mounting Bracket	Optional	
Panel mounting	Available as Standard	

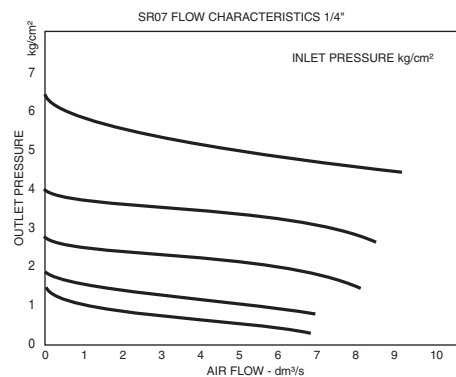
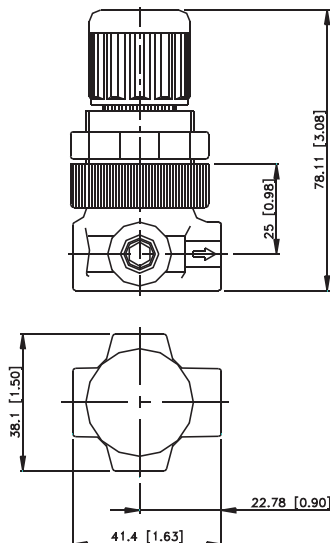

* Technical know-how, design and drawings originally from C.A. Norgren Co. USA

AIR PRESSURE REGULATOR - MINIATURE

SHAVO
FIRST NAME IN PNEUMATICS

SRO7 (G 1/8, G 1/4)

Size	Flow (dm ³ /s)	Range Kg/cm ²	Operation	Model
G 1/8	6.5 dm ³ /sec	0-7	Relieving	SRO7-121-RNKC
G 1/4	7.5 dm ³ /sec	0-7	Relieving	SRO7-221-RNKC

Option Selector

Sample Model Number → **S R O 7 2 2 1 R G K B**

Position → **0 1 2 3 4 5 6 7 8 9 10**

0	S = Shavo
1 Unit	R = Regulator
2 3 Series	07 = Miniature Series
4 Pipe Size	1 = 1/8" 2 = 1/4"
5 6 Mounting	21 = Panel Mounting (std.)
7 Diaphragm	R = Relieving N = Non-Relieving
8 Gauge	G = With Gauge N = Without Gauge
9 Secondary Pressure Rating	A = 0.07 - 0.70 kg/cm ² C = 0.21 - 2.10 kg/cm ² E = 0.35 - 3.5 kg/cm ² K = 0.70 - 7.0 kg/cm ² M = 1.00 - 10.0 kg/cm ²
10 Threading	B = BSPT _r A = NPT C = BSP Parallel

* Technical know-how, design and drawings originally from C.A. Norgren Co. USA

SHAVO

Mumbai, India.

Tel. : 022-2760 4700

Fax : 022-2760 4790

B005/2
0702